

Roof Curbs

for Vektor® Laboratory Exhaust



Greenheck's roof curbs are designed to meet the structural and design requirements of Vektor® laboratory exhaust systems. All curbs are constructed of reinforced, corrosion-resistant heavy-gauge steel to provide a solid mounting structure, designed for ease of installation.

GPFHL / GPFHD

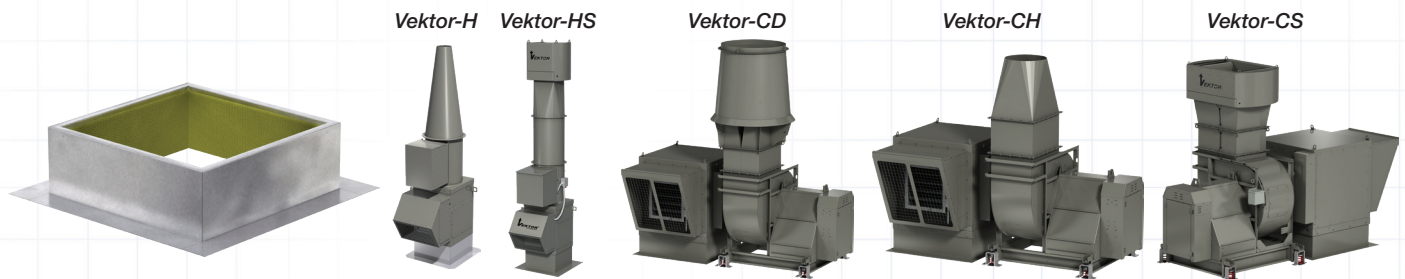

VKCURB / VKERSCURB

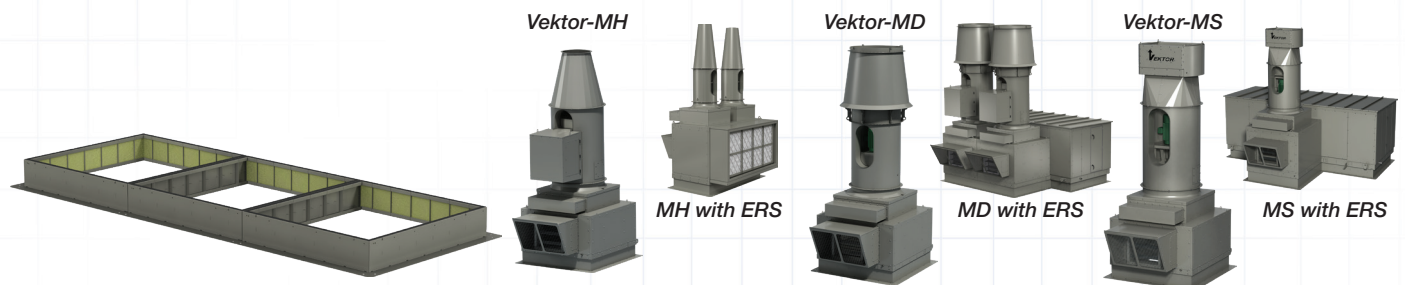

Curbs are available for mounting Vektor exhaust fans as well as single or multiple bypass air plenum systems.

Advantages:

- All roof curbs are specifically designed to handle load requirements of Vektor laboratory exhaust systems.
- Curbs can be preshipped to allow for jobsite preparation prior to Vektor laboratory exhaust system delivery.
- VKCURB and VKERSCURB: Shipped in sections to accommodate limited access installations.
- Pitched curbs are available for proper system installation on pitched roofs.
- Equipment is designed to withstand 125 mph (200 km/h) wind loads *without the use of guy wires* when installed on Greenheck curbs.

Vektor® Roof Curb Features and Options

- 1 Formed and welded, galvanized or corrosion-resistant coated steel construction
- 2 Standard curb height is 12 inches (305 mm) with optional heights up to 24 inches (610 mm)
- 3 Curbs include formed steel support framework for added structural integrity
- 4 One-inch (25 mm) insulation* is standard on all models to prevent the formation of condensation
**Vented curb model GPFHL is used with Vektor-H for UL762 grease installations. Insulation on vented curb is not available for grease applications.*
- 5 Threaded curb cap mounting holes for connection to the fan or bypass plenum curb cap (VKCURB only)
- 6 Curb cap guides help center the fan or bypass plenum on the curb (VKCURB only)
- 7 Five-inch (127 mm) flange for mounting to the roof deck

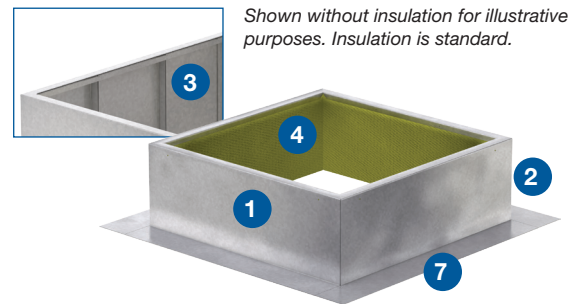

GPFHL / GPFHD

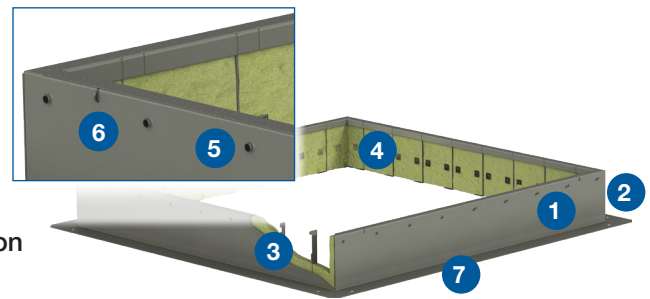

VKCURB / VKERSCURB

Features and Options	GPFHL		GPFHD	VKCURB VKERSCURB
	Vektor-H Series	Vektor-C Series	Vektor-H Series	Vektor-M Series and Vektor-M Series with ERS
Standard Construction	Galvanized (Coating Optional)	Galvanized (Coating Optional)	Galvanized (Coating Optional)	Steel coated with LabCoat™
Minimum Material Gauge	14 Gauge	14 Gauge	12 Gauge	12 Gauge
Pitched Curb	Optional	Optional	Optional*	Optional

*Maximum 24 inches (610 mm) or less.

Our Commitment

As a result of our commitment to continuous improvement, Greenheck reserves the right to change specifications without notice.

Product warranties can be found online at Greenheck.com, either on the specific product page or in the literature section of the website at Greenheck.com/Resources/Library/Literature.