

Assembly Instructions

READ THROUGH THESE INSTRUCTIONS PRIOR TO STARTING ASSEMBLY.

Document Instructions

Use Document #1016006 with fastener kits 879425 and 879426. These kits are to be used with the Vektor-MD model. The fasteners contained within the kit are to be used to attach the windband to the Vektor-MD nozzle. Use the images located within this document to locate the position of the fasteners on the unit.

Note:

Vektor-MD – Sizes 36 and smaller, nozzle is attached to the fan housing.

Vektor-MD – Sizes 40 and greater, windband and nozzle ships as individual pieces.

Assembly Instructions

1. See Greenheck Document #464652 (Installation, Operation and Maintenance Manual: Vektor-MD, Vektor-MH and Vektor-MS) for full installation instructions.
2. See image to the right to locate bolt holes. Attach windband using the provided moly-coated 316 stainless steel bolts through the bolt holes.

Tools Required

- Cordless drill (electric or pneumatic)
- 9/16 inch nut setter
- 9/16 inch wrench

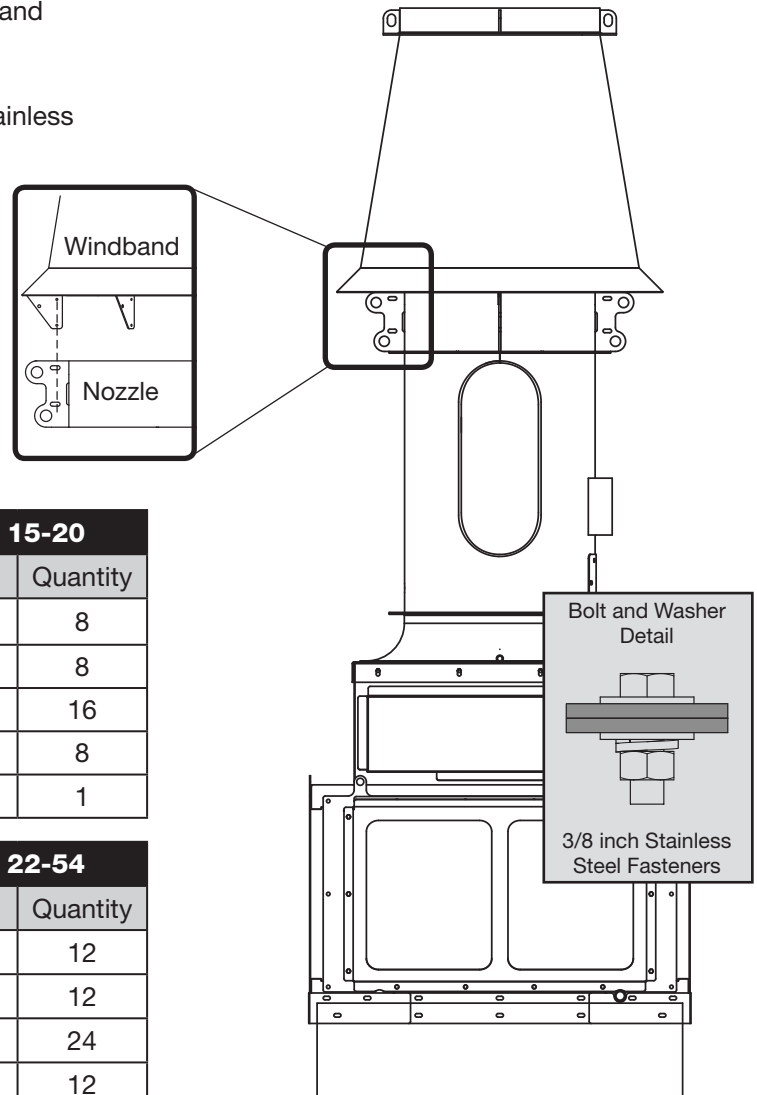

| FASTENER KIT 879425 – VEKTOR-MD SIZE 15-20 | | |
|--|---------|----------|
| Part Description | Part # | Quantity |
| CS,HH,.375-16X1.5,SS,316,MOLY | 415781 | 8 |
| NUT,HEX,.375-16,SS,316 | 415799 | 8 |
| WSHR,FLAT,.313X.05X.406X.875,SS,316 | 415800 | 16 |
| WSHR,LOCK,SPLIT,.375,SS,316 | 415810 | 8 |
| Assembly Instructions | 1016006 | 1 |

| FASTENER KIT 879426 – VEKTOR-MD SIZE 22-54 | | |
|--|---------|----------|
| Part Description | Part # | Quantity |
| CS,HH,.375-16X1.5,SS,316,MOLY | 415781 | 12 |
| NUT,HEX,.375-16,SS,316 | 415799 | 12 |
| WSHR,FLAT,.313X.05X.406X.875,SS,316 | 415800 | 24 |
| WSHR,LOCK,SPLIT,.375,SS,316 | 415810 | 12 |
| Assembly Instructions | 1016006 | 1 |