

Application

Greenheck duct access doors provide a durable, practical and inexpensive means of gaining access to components inside the ductwork. Recommended for use in low to medium pressure duct systems. HAD-10 & CAD-10 access doors are rated for up to 4½ in. (1.1 kPa) static pressure when properly installed.

Construction

	Standard
Frame Material	Galvanized steel: 6 in. x 6 in. – 12 in. x 12 in. (152mm x 152mm - 305mm x 305mm) are 24 ga. (0.7mm) Larger than 12 in. x 12 in. (152mm x 152mm) are 22 ga. (0.85mm)
Door Panels	24 ga. (.7mm) galvanized steel (both sides of insulation)
Insulation	1 in. (25mm) fiberglass
Gasket	½ in. (13mm) wide dual gasket (compressible synthetic type). Door to frame and frame to duct
Hinge	Continuous piano style
Latches	Plated steel with galvanized steel strikes



CAD-10

HAD-10

Installation

Easy installation. Use door frame as template for making the duct opening. Insert door frame into duct opening and peen or crimp mounting tabs to duct interior for a secure installation.

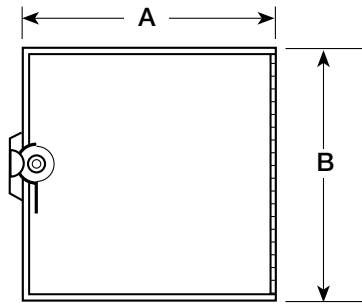
Stock Sizes	
Inches	MM
6 x 6	152 x 152
8 x 8	203 x 203
10 x 10	254 x 254
12 x 12	305 x 305
14 x 14	356 x 356
16 x 16	406 x 406
18 x 18	457 x 457
20 x 20	508 x 508
24 x 24	610 x 610
*Other sizes are available as special order	



Model HAD
Hinged Type

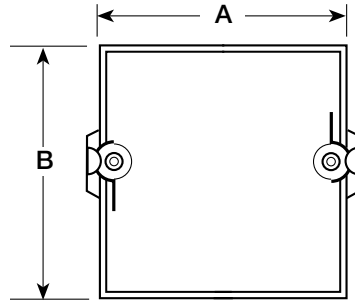

Model CAD
Cam Type

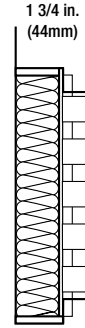

Section View

Size in. (mm)	Width 'A' in. (mm)	Height 'B' in. (mm)	Duct Opening in. (mm)	HAD Latches Quantity	CAD Latches Quantity
6 x 6 (152 x 152)	6 $\frac{1}{4}$ (159)	6 $\frac{1}{4}$ (159)	5 $\frac{1}{4}$ x 5 $\frac{1}{4}$ (133 x 133)	1	2
8 x 8 (203 x 203)	8 $\frac{1}{4}$ (210)	8 $\frac{1}{4}$ (210)	7 $\frac{1}{4}$ x 7 $\frac{1}{4}$ (184 x 184)	1	2
10 x 10 (254 x 254)	10 $\frac{1}{4}$ (260)	10 $\frac{1}{4}$ (260)	9 $\frac{1}{4}$ x 9 $\frac{1}{4}$ (235 x 235)	1	2
12 x 12 (305 x 305)	12 $\frac{1}{4}$ (311)	12 $\frac{1}{4}$ (311)	11 $\frac{1}{4}$ x 11 $\frac{1}{4}$ (286 x 286)	1	2
14 x 14 (356 x 356)	14 $\frac{1}{4}$ (362)	14 $\frac{1}{4}$ (362)	13 $\frac{1}{4}$ x 13 $\frac{1}{4}$ (337 x 337)	1	2
16 x 16 (406 x 406)	16 $\frac{1}{4}$ (413)	16 $\frac{1}{4}$ (413)	15 $\frac{1}{4}$ x 15 $\frac{1}{4}$ (387 x 387)	2	4
18 x 18 (457 x 457)	18 $\frac{1}{4}$ (464)	18 $\frac{1}{4}$ (464)	17 $\frac{1}{4}$ x 17 $\frac{1}{4}$ (438 x 438)	2	4
20 x 20 (508 x 508)	20 $\frac{1}{4}$ (514)	20 $\frac{1}{4}$ (514)	19 $\frac{1}{4}$ x 19 $\frac{1}{4}$ (489 x 489)	2	4
24 x 24 (610 x 610)	24 (610)	24 (610)	23 x 23 (584 x 584)	2	4

Document Links

[Damper Warranty](#)



[Damper Product Selection Guide](#)



[Specifications](#)

