

INSTALLATION CHECKLIST

1

Install I/O Processor



- Verify I/O Processor is mounted near hood with Keypad.
- Verify voltage select switch (115V or 230V) is properly set.
- Verify input wiring (115V or 230V) is connected.
- Verify output wiring is connected to hood lights.

2

Install Electronic Motor Starter



- Verify voltage and HP rating is same as motor.
- Verify separate conduit is installed for input & output wiring.
- Verify input wiring is connected to L1, L2, & L3, and ground.
- Verify motor wiring is connected to U, V, W (or T1, T2, T3).
- Verify output wiring does not power any MUA control circuit.
- Verify each VFD is connected in series to the processor.
- Verify fire suppression interlock connected to MUA VFD.

3

Install Keypad



- Verify Keypad is mounted on hood with I/O Processor.
- Verify optional Keypad for MUA heat is installed, if applicable.
- Verify cable is connected to back of Keypad.
- Verify screws for cover plate fit flush inside holes.
- Verify top & bottom flaps of overlay are adhered to cover.
- Verify aluminum caulk is applied to seal gaps along edges.

4

Install Temperature Sensor



- Verify one temp sensor is installed on each exhaust duct.
- Verify optional MUA temp sensor is installed, if applicable.
- Verify 'quick seal' fitting is tight and secure on each duct.
- Verify cable connected and strain relief tightened.
- Verify temp sensors connected in series using temperature Y cables, if applicable.
- Verify any existing duct insulation is patched, if applicable.

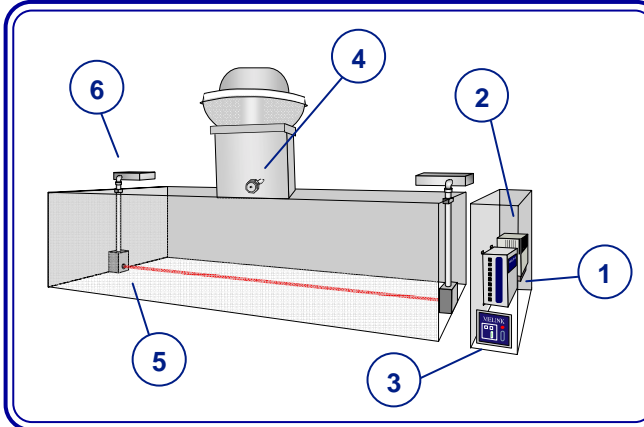

5

Install Optic Sensors (if applicable)



- Verify housings are aligned on opposite ends of hood.
- Verify no obstructions inside hood can block infrared beam.
- Verify optic cable is connected to each optic board.
- Verify 'quick seal' fittings are tight & secure on top of hood.
- Verify each cable is protected inside slot on top of purge pipe.
- Verify switch on receiver is set according to hood length.

6

Install Air Purge Unit Boxes



- Verify APUs are properly secured to purge pipe.
- Verify sensor cables are connected to the header boards.
- Verify a cable is connecting each APU Box via the header.
- Verify a cable is connecting the nearest APU Box to the IOP.
- Verify that the strain-reliefs are tightened.

7



- Verify wire ties are used to secure cables above each hood.
- Verify cables are not strapped along electric conduit.
- Verify switch on processor is set for keypad or remote temp.
- Verify cable connected to proper channel for each hood.
- Verify MUA temp sensor connected, if applicable.
- Verify auxilliary wiring to proper terminals, if applicable.

8

Certify Installation (Fax to 513-527-7023)

- I hereby certify the checked items have been completed.

Concept: _____ Store #: _____

Location: _____

Hood # : _____ Date: _____

Contractor: _____

Phone: _____

Fax: _____

Signature: _____

START-UP CHECKLIST

1

Turn On Power to I/O Processor



- Turn on power at respective circuit breaker.
- Verify proper voltage at input terminals.
- Turn on power at switch inside enclosure.
- Verify power LED is illuminated inside enclosure.

2

Turn On Power to Electronic Motor Starter



- Turn on power at respective circuit breaker(s).
- Verify proper voltage at input terminals.
- Verify keypad is illuminated and cooling fan is operating.
- Verify over-current setting is 10% higher than motor FLA.

3

Press Light and Fan Buttons at Keypad



- Verify lights turn on inside hood(s).
- Verify fans operating at less than full speed at the bar graph.
- Verify digital display scrolls through each hood.
- Verify clean LED is not illuminated and optics calibrated.
- Verify fault LED is not illuminated and no faults present.
- Verify air pressure at optic sensors from APUs.

4

Program the System



- Enter set-up mode by pressing both keys for 12 seconds.
- Verify proper settings in Simplissimo hood/system menu.
- Exit set-up mode and verify proper system operation.
- Verify fans go to full speed when breaking infrared beam.
- Verify fan speed increases with cooking equipment on.
- Lock out Keypad by pressing both keys for 12 seconds.

LIGHT SWITCH

(turns hood lights on and off)

FAN SWITCH

(turns fans on and off)

CLEAN LIGHT

(flashes red/green to indicate that Optic Sensors need cleaning)

BYPASS SWITCH

(operates all fans at 100% speed for a selected time interval and can also reset the system)

BAR GRAPH

(indicates the % fan speed during normal operation and indicates a menu selection in the programming mode. Also Indicates the type of fault for easy trouble-shooting)

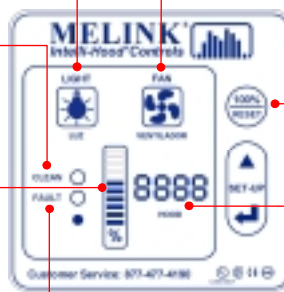

FAULT LIGHT

DIGITAL DISPLAY

(indicates the hood number during normal operation; and displays "E" when in 100% bypass)

5

Verify Correct Fan Operation

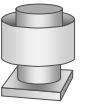

- Verify correct fan rotation on roof (switch any two motor leads).
- Verify current draw is less than motor FLA rating.
- Record motor frequency, FLA, and operating current at 100%.
- Verify proper connection of control cable from IOP to MUA unit (if applicable).
- Verify MUA unit will heat properly at both maximum and minimum speeds (if applicable).
- Verify OA dampers modulate to appropriate positions on controlled RTUs (if applicable).

6

Press 100% Button



- Verify fans go to 100% speed and the letter "E" is displayed on Keypad (with each hood designation).
- Verify amps at motor starter (VFD) less than motor FLA.
- Monitor fans at 100% speed for at least 30 minutes.
- Balance hoods by adjusting sheaves or maximum speed.

7

Educate Operations Personnel



- Review system operation with key personnel.
- Review maintenance procedures with key personnel.
- Provide Operations & Maintenance handout to manager.
- Provide contact information for local service.
- Affix Melink label next to each Keypad or hood switch.
- Contact Melink Intelli-Hood plant to verify proper start-up.

8

Certify Start-Up (Fax to 513-527-7023)

- I hereby certify the checked items have been completed.

Concept: _____ Store #: _____

Location: _____

Hood # : _____ Date: _____

Contractor: _____

Phone: _____

Fax: _____

Signature: _____